



# a.b.e.<sup>®</sup> Construction Chemicals METHODOLOGY Tanking & Retaining Walls

## SURFACE PREPARATION

Surface areas should be dry, clean and sound, free of voids, sharp protrusions or contaminants. The surfaces shall have a light steel trowelled or fine wood float finish.

## SUBSTRATES AND FALLS

Screeds are to be sand cement laid to minimum falls of 1 in 60, the strength and thickness as per engineers specification. The moisture content is not to exceed 7% prior to torchon applications.

Should light weight screeds be employed an additional sand cement screed is to be placed on top of the light weight screed, the strength and thickness as per engineers specification. Under no circumstances must the torchon material be applied directly onto the light weight screeds.

Special care must be given to all expansion/construction joints, refer to you're a.b.e.<sup>®</sup> Technical Representative concerned for specific details.

## PRIMING

### 1. New Areas

Prime all surfaces with **bitu.<sup>®</sup>prime**, including all verges, and around outlets and protrusions and allow the solvent to flash off. Extremely porous surfaces should be re-primed.

### 2. Rejuvenation

Strip existing waterproofing before priming all surfaces with **bitu.<sup>®</sup>prime**, including all verges, around outlets and protrusions and allow the solvent to flash off. Some existing waterproofing materials may be overlaid only in consultation with the a.b.e.<sup>®</sup> Technical Representative concerned.

## SPECIFICATION

**Index Fidia P**, South African Agreement Certified (Certificate No. 97/261)

Full bore outlets, pipe upstands to have a square metre of **Index Fidia P 4mm** bonded to the surface including their gussets. All internal and external corners to have a gusset fitted, 100mm x 100mm, using **Index Fidia P 4mm** prior to the commencement of the waterproofing application.

Apply the first layer **Index Fidia P 3mm** or **abe<sup>®</sup> unigum 3mm**, non-woven polyester reinforced.

Apply the second layer, **Index Fidia P 4mm** or **abe<sup>®</sup> unigum 4mm**, non-woven polyester reinforced, on top of the first layer, ensuring both layers are fully bonded by means of 'torchon fusion' using propane gas, having side and end laps of 100mm and 150mm respectively.

Where vegetation or plant roots may be present then replace the second layer with **Index Defend H 4mm** anti-root.

The rolls are to run parallel to each other, centrally staggered to prevent joints overlapping.

See data sheet '**Six Golden Rules**'.

## PROTECTION/DRAINAGE LAYER

All bitumen membranes exposed to sunlight are to be coated with 2 coats of **silvakote** for UV protection. Prior to backfilling a suitable protection board like **dura.<sup>®</sup>sheet** 10mm thick or **abe.<sup>®</sup>drain** must be positioned against the waterproofing membrane followed by a stone free river sand followed by general back fill material to prevent damage to the waterproofing membrane by stones, rocks, rakes or shovels etc. or for drainage include **abe.<sup>®</sup>drain G** against the waterproofing followed by a stone free river sand followed by general back fill material to prevent damage to the **abe.<sup>®</sup>drain G** by stones, rocks, rakes or shovels etc. to assist in leading excess water to suitable agricultural drains and outlets as per engineers detail.

## FLASHING

Counter flashing over the balance of the parapet is recommended using **super laycryl** or **super laykold** incorporating **abe® membrane**, details as recommended in our data sheet. Ensure the lap over the torched membrane is at least 150mm.

## PROTECTION LAYERS

All plain exposed surfaces are to be treated with 2 coats of **silvakote** as protection layer against UV rays. The coating should be applied 6 to 8 weeks after torching process to allow the surface to oxidise slightly thus providing good adhesion of the coating.

## DRAINAGE OUTLETS

Specific attention must be given to the detail work when waterproofing the outlets to prevent ingress of moisture.

## GENERAL

**Index** waterproofing membranes shall only be installed by contractors accredited by **a.b.e.® Construction Chemicals Limited**.

Care must always be taken when working with open flames, potential fire hazard, and molten bitumen from the process, employ safety equipment and clothing where necessary.

All the products are to be applied in accordance with the manufacturers instructions.

All relevant data sheets are to be carefully read for additional information.

## IMPORTANT NOTE

This data sheet is issued as a guide to the use of the product(s) concerned. Whilst **a.b.e.® Construction Chemicals Limited** endeavours to ensure that any advice, recommendation, specification or information is accurate and correct, the company cannot - because **a.b.e.®** has no direct or continuous control over where and how **a.b.e.®** products are applied - accept any liability either directly or indirectly arising from the use of **a.b.e.®** products, whether or not in accordance with any advice, specification, recommendation, or information given by the company.

## FURTHER INFORMATION

Where other products are to be used in conjunction with this material, the relevant technical data sheets should be consulted to determine total requirements. **a.b.e.® Construction Chemicals Limited** has a wealth of technical and practical experience built up over years in the company's pursuit of excellence in building and construction technology.



**TYPICAL TANKING DETAIL**

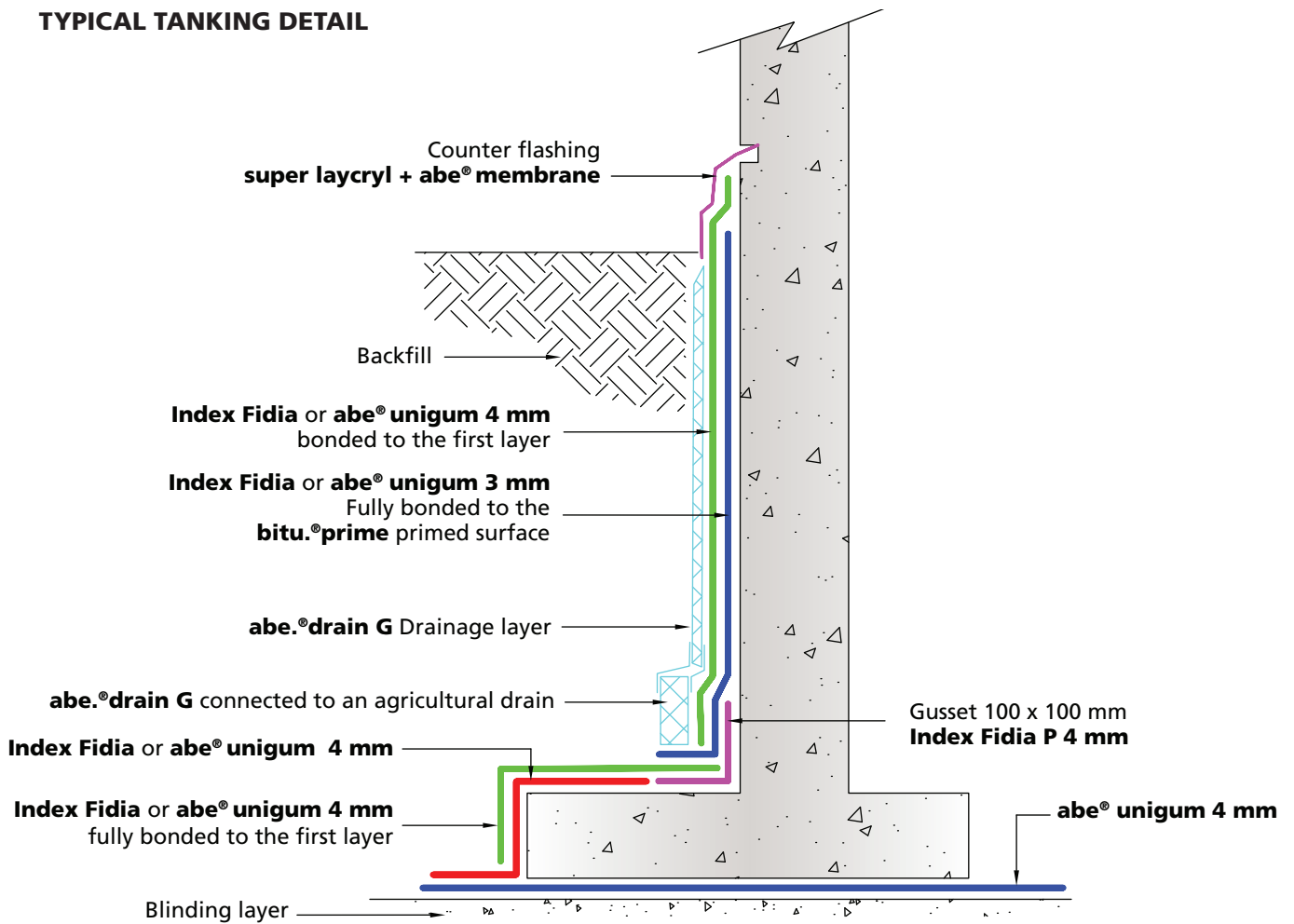

a.b.e.® is an ISO 9001:2008 registered company  
 PO Box 5100, Boksburg North, 1461, South Africa  
 Website: [www.abe.co.za](http://www.abe.co.za) | Tel: +27(0) 11 306 9000  
 Durban | Johannesburg | Cape Town | Port Elizabeth | East London | Bloemfontein | George

a.b.e.® is a Chryso Group Company

